

Lockable Safety Isolator

The Isolator range offers really positive double pole switch isolation with a lockable cover to added security and safety. The isolators can be fitted with fuse carriers, MCBs or controls for Festive Lighting and feature the innovative Charles Endirect sliding interlock. This safety feature means that the fuse can only be withdrawn when the switch is in 'off' position. The range consists of four different sized models from 1 to 4 module widths, i.e. L1, L2, L3 and L4.



L1



L2



L3



L4

CEL Switch Disconnecter and Fuse Carrier

The CEL switch disconnecter and fuse carrier are manufactured to the highest specification. Notably, the switch has been certified at a utilisation category of AC22A and, as such is capable of switching a high inductive load. The fuse carrier accepts BS88 cartridge fuse (MD for 415V, LD for 230V).

These products have been independently tested and carry the KEMA* approval and comply with the latest International Standards.

*KEMA International Testing & Certification Laboratory (www.KEMA.com)

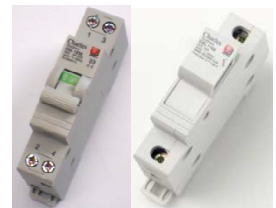

Switch
CEL1232

Fuse
Carrier
CEL1132

Extension Boxes, Terminals and Glandplates

For SWA cables up to 25mm² (35mm² circular), the CEL range of extension boxes provide versatility, ease of termination and quick installation. Designed for strength with moulded DIN rails and terminal clamps the boxes fit onto the isolators and accept a range of gland plates – plastic plates for use with CETs, brass plates with holes to accept compression glands and brass plates fitted with ferrules. Manufactured from brass, the live, neutral and earth terminals are fully insulated.

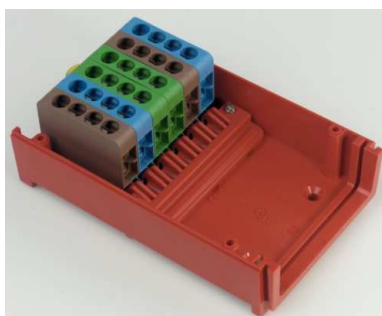

Terminal Rack
(TR**)



X1/F4 with
Ferrule plate



X3/H6 with Hole
plate with BW20

GLAND PLATES AND EXTENSION BOXES

Isolator Enclosure	Gland Plates	Extension Boxes and Their Gland Plates	Dims (mm)
L1	Plastic Grommet	N/A	142 x 39 x 82
L2	A* = Plastic	X6 - accepts A, B and C Gland Plates	142 x 57 x 82
	B* = Brass Holes		
	C* = Brass Ferrules		
L3	K* = Plastic	X0 - accepts X1, X2, X3 and D, E and F Gland Plates	154 x 79 82
	M* = Brass Holes		
	P* = Brass Ferrules	X4 - accepts K, M and P Gland Plates	
L4	D* = Plastic	X1 - accept D, E and F Gland Plates	168 x 95 90
	E* = Brass Holes	X2 - accept D, E and F Gland Plates	
	F* = Brass Ferrules	X3 - accepts G, H and J Gland Plates	
X5 - fits onto X3 for extra termination space and accepts G, H and J Plates			

* Digit to denote number and size of holes/ferrules

Termination Racks

There is a wide range of terminal block arrangements in the extension boxes to facilitate the termination and looping of larger cables. These are Termination Racks (.../TR../...).

Selection Chart for Standard Types of Isolators

Guide to using the chart in following pages:

To identify required product :

1. Select incoming cable size in first column, e.g. 4mm, 3C
2. Select incoming cable configuration in second column, e.g. single looped
3. Select number of outgoing fused circuits, e.g. 1 upward circuit
4. Select gland option, e.g. BW glands

In the example above (4.0mm 3C incoming looped with 1 upward fused circuit with compression glands), the required unit is L2/SFE/B1.

(Note: the same unit with a 6 amp MCB would be L2/SM6E/B1.)

Isolator with Pre-Wired Tails Isolator

Our standard double pole, single fuse isolator can be supplied fitted with an internal earth, plastic gland plate and incoming tails including two earth tails, one with 8mm crimp

Order Reference: L2/SFE/A1/6.0/350+350E+510E/M8 Lug Tails

Isolator Selection Chart for Electricity Board Supply

Incoming Cable Size	Incoming Cable 2 x Double Insulated Tails	Out Going Fused Circuits	Glands	LSI Order Reference	Dimensions H x W x D (mm)
2.5mm - 6.0mm	DI Tails x 2	1 x Up		L2/SF/A1	142 x 57 x 82
Pre-fitted incoming tails		1 x Up	L2/SFE/A1/6.0/350+350E+510E/M8 Lug		142 x 57 x 82
2.5mm - 6.0mm	DI Tails x 2	2 x Up		L3/S2F/K3	154 x 79 x 82
2.5mm - 6.0mm	DI Tails x 2	3 x Up		L4/S3FNE/D3	168 x 95 x 90
2.5mm - 6.0mm	DI Tails + 1 x 6mm Fused Downward Spur	1 x Up	BW/CW20	L3/S2F/M3 (1D)	154 x 79 x 82
		1 x Down	Ferrules	L3/S2F/P4 (1D)	
2.5mm - 6.0mm	DI Tail + 1 x 6mm Fused Downward Spur	2 x Up	BW20 CW20(CEL)	L4/S3FNE/E3(1D)	168 x 95 x 90
		1 x Down	Ferrules	L4/S3FNE/F12(1D)	
2.5mm - 6.0mm	DI Tails + 2 x 6mm Fused Downward Spur	1 x Up	BW/CW20	L4/S3F/TR12/H6	312 x 95 x 90
		2 x Down	Ferrules	L4/S3F/TR12/J7	

When MCB is required substitute F for M plus MCB Current Rating, e.g. 6 Amp MCB = M6

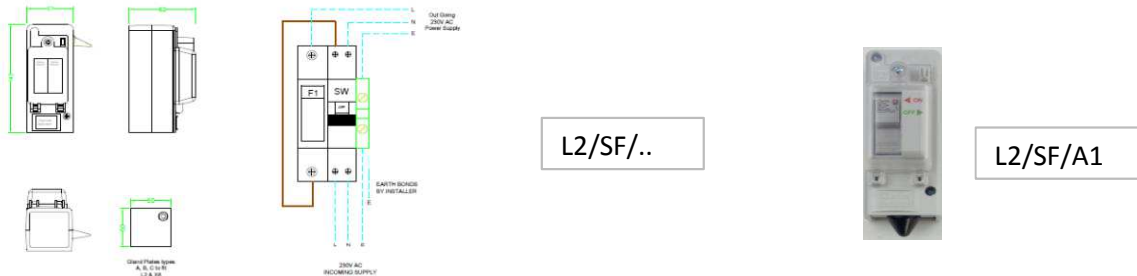

Isolator Selection Chart for Private Supply Networks

Incoming Cable Size	Incoming Cable Configuration	Out Going Fused Circuits	Glands	LSI Order Reference	Dimensions H x W x D (mm)
2.5mm. 4.0mm. 3C.	Single	1 x Up	BW/CW20 Ferrules CET	L2/SFE/B1 L2/SFE/C2 L2/SFE/A1	142 x 57 x 82
2.5mm. 4.0mm. 3C.	Single or Two Looped	1 x Up	BW/CW20 Ferrules CET	L3/SF/M3 L3/SF/P4 L3/SF/K3	154 x 79 x 82
2.5mm. 4.0mm. 3C.	Three Looped (Two Looped + Unfused Spur)	1 x Up	BW/CW20 Ferrules CET	L3/SF/TR2/X0/E6 L3/SF/TR2/X0/F6 L3/SF/TR2/X0/D6	290 x 95 x 82
2.5mm. 4.0mm. 3C.	Single or Two Looped	2 x Up	BW/CW20 Ferrules CET	L3/S2F/M3 L3/S2F/P4 L3/S2F/K3	154 x 79 x 82
2.5mm. 4.0mm. 3C.	Three Looped (Two Looped + Unfused Spur)	2 x Up	BW/CW20 Ferrules CET	L3/S2F/TR2/X0/E6 L3/S2F/TR2/X0/F6 L3/S2F/TR2/X0/D6	290 x 95 x 82
2.5mm. 4.0mm. 3C.	Single or Two Looped	3 x Up	BW/CW20 Ferrules CET	L4/S3FNE/E3 L4/S3FNE/F4 L4/S3FNE/D3	168 x 95 x 90
2.5mm. 4.0mm. 3C.	Three Looped (Two Looped + Unfused Spur)	3 x Up	BW/CW20	L4/S3FN/TR4/E6	312 x 95 x 90
			Ferrules	L4/S3FN/TR4/F6	312 x 95 x 90
			CET	L4/S3FNE/TR4/D3	312 x 95 x 90

When MCB is required substitute F for M plus MCB Current Rating, e.g. 6 Amp MCB = M6



Incoming Cable Size	Incoming Cable 2 x Double Insulated Tails	Out Going Fused Circuits	Glands	LSI Order Reference	Dimensions H x W x D (mm)
6.00mm. 3C.	Single	1 x Up	BW/CW20 Ferrules CET	L2/SFE/B1 L2/SFE/C2 L2/SFE/A1	142 x 57 x 82
6.00mm. 3C.	Single	2 x Up	BW/CW20 Ferrules CET	L3/S2F/M3 L3/S2F/P4 L3/S2F/K3	154 x 79 x 82
6.00mm. 3C.	Single	3 x Up	BW/CW20 Ferrules CET	L4/S3FNE/E3 L4/S3FNE/F4 L4/S3FNE/D3	168 x 95 x 90
6.00mm. 3C.	Two Looped	1 X Up	BW/CW20 Ferrules CET	L3/SF/TR2/M3 L3/SF/TR2/P4 L3/SF/TR2/K3	254 x 79 x 82
6.00mm. 3C.	Three Looped (Two Looped + Unfused Spur)	1 x Up	BW/CW20 Ferrules CET	L3/SF/TR2/X0/E6 L3/SF/TR2/X0/F6 L3/SF/TR2/X0/D6	290 x 95 x 82
6.00mm. 3C.	Two Looped	2 x Up	BW/CW20 Ferrules CET	L3/S2F/TR2/M3 L3/S2F/TR2/P4 L3/S2F/TR2/K3	254 x 79 x 82
6.00mm. 3C.	Three Looped (Two Looped + Unfused Spur)	2 x Up	BW/CW20 Ferrules CET	L3/S2F/TR2/X0/E6 L3/S2F/TR2/X0/F6 L3/S2F/TR2/X0/D6	290 x 95 x 82
6.00mm. 3C.	Two Looped	3 x Up	BW/CW20 Ferrules CET	L4/S3FN/TR4/E3 L4/S3FN/TR4/F4 L4/S3FN/TR4/D3	312 x 95 x 90
6.00mm. 3C.	Three Looped (Two Looped + Unfused Spur)	3 x Up	BW/CW20 Ferrules CET	L4/S3FN/TR4/E6 L4/S3FN/TR4/F6 L4/S3FN/TR4/D6	312 x 95 x 90
6.00mm. 3C.	Single + 1 x 6mm Fused Downward Spur	1 x Up 1 x Down	BW/CW20 Ferrules CET	L3/S2F/M3(1D) L3/S2F/P4(1D) L3/S2F/K3(1D)	154 x 79 x 82
6.00mm. 3C.	Single + 1 x 6mm Fused Downward Spur	2 x Up 1 x Down	BW/CW20 Ferrules CET	L4/S3FNE/E3(1D) L4/S3FNE/F4(1D) L4/S3FNE/D3(1D)	168 x 95 x 90
6.00mm. 3C.	Looped + 1 x 6mm Fused Downward Spur	1 x Up 1 x Down	BW/CW20 Ferrules CET	L3/S2F/TR9/X0/E6 L3/S2F/TR9/X0/F6 L3/S2F/TR9/X0/D6	290 x 95 x 82
6.00mm. 3C.	Single + 1 x 6mm Fused Downward Spur	2 x Up 1 x Down	BW/CW20 Ferrules CET	L4/S3FN/TR24/E3 L4/S3FN/TR24/F4 L4/S3FN/TR24/D3	312 x 95 x 90
6.00mm. 3C.	Looped + 1 x 6mm Fused Downward Spur	2 x Up 1 x Down	BW/CW20 Ferrules CET	L4/S3FN/TR24/E6 L4/S3FN/TR24/F6 L4/S3FN/TR24/D6	312 x 95 x 90
6.00mm. 3C.	Single + 2 x 6mm Fused Downward Spur	1 x Up 2 x Down	BW/CW20 Ferrules CET	L4/S3F/TR12/H6 L4/S3F/TR12/J7 L4/S3F/TR12/G6	312 x 95 x 99
6.00mm. 3C.	Looped + 2 x 6mm Fused Downward Spur	1 x Up 2 x Down	BW/CW20 Ferrules CET	L4/S3F/TR12/H10 L4/S3F/TR12/J20 L4/S3F/TR12/G10	312 x 95 x 99
6.00mm. 4C.(TP&N)	Single or Two Looped	1 x Up (230V)	BW/CW20 Ferrules CET	L4/SF/TR5/E3 L4/SF/TR5/F4 L4/SF/TR5/D3	377 x 95 x 90

When MCB is required substitute F for M plus MCB Current Rating, e.g. 6 Amp MCB = M6

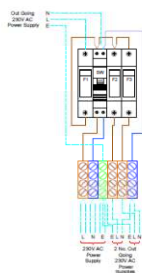
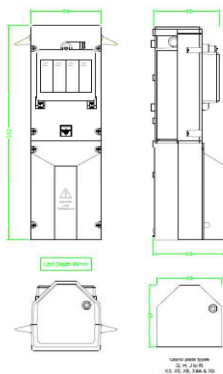

L4/S3F/TR12/...



L4/S3F/ ...

Incoming Cable Size	Incoming Cable 2 x Double Insulated Tails	Out Going Fused Circuits	Glands	LSI Order Reference	Dimensions H x W x D (mm)
10.00mm. 3C.	Single	1 x Up	BW/CW20 Ferrules CET	L3/SF/M3 L3/SF/P4 L3/SF/K3	154 x 79 x 82
10.00mm. 3C.	Single	2 x Up	BW/CW20 Ferrules CET	L3/S2F/M3 L3/S2F/P4 L3/S2F/K3	154 x 79 x 82
10.00mm. 3C.	Single	3 x Up	BW/CW20 Ferrules CET	L4/S3FNE/E3 L4/S3FNE/F4 L4/S3FNE/D3	168 x 95 x 90
10.00mm. 3C.	Two Looped	1 x Up	BW/CW20 Ferrules CET	L3/SF/TR2/M3 L3/SF/TR2/P4 L3/SF/TR2/K3	254 x 79 x 82
10.00mm. 3C.	Three Looped (Two Looped + Unfused Spur)	1 x Up	BW/CW20 Ferrules CET	L3/SF/TR2/X0/E6 L3/SF/TR2/X0/F6 L3/SF/TR2/X0/D6	290 x 95 x 82
10.00mm. 3C.	Two Looped	2 x Up	BW/CW20 Ferrules CET	L3/S2F/TR2/M3 L3/S2F/TR2/P4 L3/S2F/TR2/K3	254 x 79 x 82
10.00mm. 3C.	Three Looped (Two Looped + Unfused Spur)	2 x Up	BW/CW20 Ferrules CET	L3/S2F/TR2/X0/E6 L3/S2F/TR2/X0/F6 L3/S2F/TR2/X0/D6	290 x 95 x 82
10.00mm. 3C.	Two Looped	3 x Up	BW/CW20 Ferrules CET	L4/S3FN/TR4/E3 L4/S3FN/TR4/F4 L4/S3FN/TR4/D3	312 x 95 x 90
10.00mm. 3C.	Three Looped (Two Looped + Unfused Spur)	3 x Up	BW/CW20 Ferrules CET	L4/S3FN/TR4/E6 L4/S3FN/TR4/F6 L4/S3FN/TR4/D6	312 x 95 x 90
10.00mm. 3C.	Single or Looped + 1 x 10mm Fused Downward Spur	1 x Up 1 x Down	BW/CW20 Ferrules CET (Single) CET (Looped)	L3/S2F/TR9/X0/E6 L3/S2F/TR9/X0/F6 L3/S2F/TR9/K3 L3/S2F/TR9/X0/D6	290 x 95 x 82 290 x 95 x 82 254 x 79 x 82 290 x 95 x 82
10.00mm. 3C.	Single + 1 x 10mm Fused Downward Spur	2 x Up 1 x Down	BW/CW20 Ferrules CET	L4/S3FN/TR24/E3 L4/S3FN/TR24/F4 L4/S3FN/TR24/D3	312 x 95 x 90
10.00mm. 3C.	Single or Looped + 1 x 10mm Fused Downward Spur	2 x Up 1 x Down	BW/CW20 Ferrules CET	L4/S3FN/TR24/E6 L4/S3FN/TR24/F6 L4/S3FN/TR24/D6	312 x 95 x 90
10.00mm. 3C.	Single or Looped + 2 x 6mm Fused Downward Spur	1 x Up 2 x Down	BW/CW20 Ferrules CET (Single) CET (Looped)	L4/S3F/TR12/H10 L4/S3F/TR12/J20 L4/S3F/TR12/G6 L4/S3F/TR12/G10	312 x 95 x 99
10.00mm. 4C.(TP&N)	Single or Two Looped	1 x Up (230V)	BW/CW25 Ferrules CET	L4/SF/TR5/E4 L4/SF/TR5/F4 L4/SF/TR5/D4	377 x 95 x 99

When MCB is required substitute F for M plus MCB Current Rating, e.g. 6 Amp MCB = M6

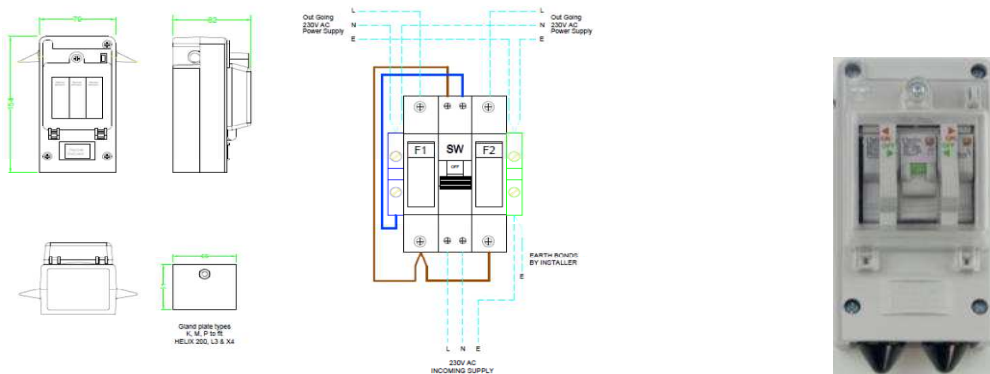

L3/S2F/K3

L3/S2F/ ...

Incoming Cable Size	Incoming Cable 2 x Double Insulated Tails	Out Going Fused Circuits	Glands	LSI Order Reference	Dimensions H x W x D (mm)
16.00mm. 3C.	Single or Two Looped	1 x Up	BW/CW25 Ferrules CET	L4/SF/TR4/E4 L4/SF/TR4/F4 L4/SF/TR4/D3	312 x 95 x 90
16.00mm. 3C.	Three Looped (Two Looped + Unfused Spur)	1 x Up	BW/CW25 Ferrules CET	L4/SF/TR8/H7 L4/SF/TR8/J7 L4/SF/TR8/G6	377 x 95 x 99
16.00mm. 3C.	Single or Two Looped	2 x Up	BW/CW25 Ferrules CET	L4/S2F/TR4/E4 L4/S2F/TR4/F4 L4/S2F/TR4/D3	312 x 95 x 90
16.00mm. 3C.	Three Looped (Two Looped + Unfused Spur)	2 x Up	BW/CW25 Ferrules CET	L4/S2F/TR8/H7 L4/S2F/TR8/J7 L4/S2F/TR8/G6	377 x 95 x 99
16.00mm. 3C.	Single or Two Looped	3 x Up	BW/CW25 Ferrules CET	L4/S3FN/TR4/E4 L4/S3FN/TR4/F4 L4/S3FN/TR4/D3	312 x 95 x 90
16.00mm. 3C.	Three Looped (Two Looped + Unfused Spur)	3 x Up	BW/CW25 Ferrules CET	L4/S3FN/TR8/H7 L4/S3FN/TR8/J7 L4/S3FN/TR8/G6	377 x 95 x 99
16.00mm. 3C.	Single or Looped + 1 x 10mm Fused Downward Spur	1 x Up 1 x Down	BW/CW25 Ferrules CET (Single) CET (Looped)	L4/S2F/TR10/H8 L4/S2F/TR10/J7 L4/S2F/TR24/D3 L4/S2F/TR10/G6	312 x 95 x 99 312 x 95 x 99 312 x 95 x 90 312 x 95 x 99
16.00mm. 3C.	Single or Looped + 1 x 10mm Fused Downward Spur	2 x Up 1 x Down	BW/CW25 Ferrules CET (Single) CET (Looped)	L4/S3FN/TR10/H8 L4/S3FN/TR10/J7 L4/S3FN/TR24/D3 L4/S3FN/TR10/G6	312 x 95 x 99 312 x 95 x 99 312 x 95 x 90 312 x 95 x 99
16.00mm. 4C.(TP&N)	Single or Two Looped	1 x Up (230V)	BW/CW25 Ferrules CET	L4/SF/TR5/E4 L4/SF/TR5/F4 L4/SF/TR5/D4	377 x 95 x 90

When MCB is required substitute F for M plus MCB Current Rating, e.g. 6 Amp MCB = M6

Incoming Cable Size	Incoming Cable Configuration	Out Going Fused Circuits	Glands	LSI Order Reference	Dimensions H x W x D (mm)
25.00mm. 3C.	Single or Two Looped	1 x Up	BW/CW25 Ferrules CET	L4/SF/TR4/E4 L4/SF/TR4/F4 L4/SF/TR4/D4	312 x 95 x 90
25.00mm. 3C.	Three Looped (Two Looped + Unfused Spur)	1 x Up	BW/CW25 Ferrules CET	L4/SF/TR8/H7 L4/SF/TR8/J7 L4/SF/TR8/G7	377 x 95 x 99
25.00mm. 3C.	Single or Two Looped	2 x Up	BW/CW25 Ferrules CET	L4/S2F/TR4/E4 L4/S2F/TR4/F4 L4/S2F/TR4/D4	312 x 95 x 90
25.00mm. 3C.	Three Looped (Two Looped + Unfused Spur)	2 x Up	BW/CW25 Ferrules CET	L4/S2F/TR8/H7 L4/S2F/TR8/J7 L4/S2F/TR8/G7	377 x 95 x 99
25.00mm. 3C.	Single or Two Looped	3 x Up	BW/CW25 Ferrules CET	L4/S3FN/TR4/E4 L4/S3FN/TR4/F4 L4/S3FN/TR4/D4	312 x 95 x 90
25.00mm. 3C.	Three Looped (Two Looped + Unfused Spur)	3 x Up	BW/CW25 Ferrules CET	L4/S3FN/TR8/H7 L4/S3FN/TR8/J7 L4/S3FN/TR8/G7	377 x 95 x 99
25.00mm. 3C.	Single or Looped + 1 x 10mm Fused Downward Spur	1 x Up 1 x Down	BW/CW25 Ferrules CET (Single) CET	L4/S2F/TR10/H8 L4/S2F/TR10/J7 L4/S2F/TR24/D4 L4/S2F/TR10/G8	312 x 95 x 99 312 x 95 x 99 312 x 95 x 90 312 x 95 x 99
25.00mm. 3C.	Single or Looped + 1 x 10mm Fused Downward Spur	2 x Up 1 x Down	BW/CW25 Ferrules CET (Single) CET (Looped)	L4/S3FN/TR10/H8 L4/S3FN/TR10/J7 L4/S3FN/TR24/D4 L4/S3FN/TR10/G8	312 x 95 x 99 312 x 95 x 99 312 x 95 x 90 312 x 95 x 99
25.00mm. 4C.(TP&N)	Single or Two Looped	1 x Up (230V)	BW/CW32 Ferrules CET	L4/SF/TR6/H27 L4/SF/TR5/F23 L4/SF/TR7/D4	377 x 95 x 99 377 x 95 x 90 377 x 95 x 90

When MCB is required substitute F for M plus MCB Current Rating, e.g. 6 Amp MCB = M6

For applications to suit 35mm cables please contact CEL Customer Services Team for assistance:
Tel: 01963 828400 info@charlesendirect.com